

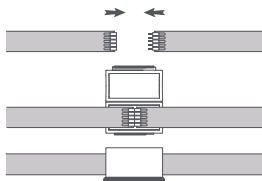

LED Strip T1 User Manual

Product Introduction

The Aqara LED Strip T1 is a multipurpose lightstrip that not only provides high-quality lighting with bright whites, but also can display multiple colors at once and be used in smart home automations with other Aqara or third-party devices.

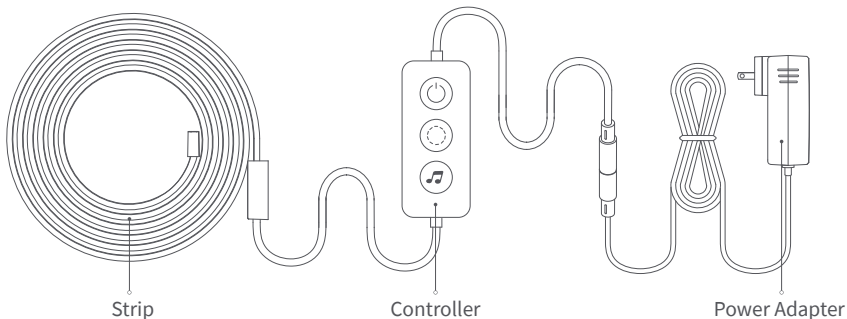

The basic Strip of this product is 2 m long. If you need to connect longer Strips, you may buy the extra extension kit (the extension kit number is RLSE-K01D). After the original Strip and that of the extension kit are connected, the joint shall be fastened by the buckle. You need to set the actual length of the Strip within the app to activate the extended Strip.

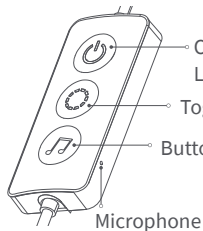

Product Installation

1. Select a suitable plug, insert the plug into the power adapter, and turn it clockwise 45°.

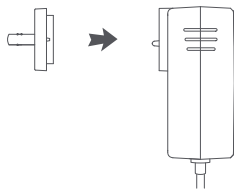

2. Connect the light strip and the controller according to the arrow.

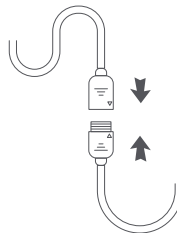

3. Clean the surface where the light strip will be installed, keep the installation surface flat, smooth and dry, tear off the 3M protective paper on the back of the light strip, stick the light strip on the installation surface, and press the light strip repeatedly with your hands to ensure that the light strip is firmly pasted .

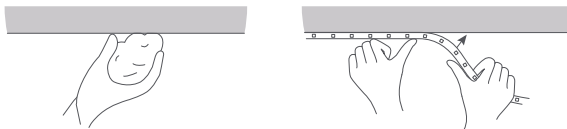

4. Connect the controller and the power adapter, and finally turn on the power.

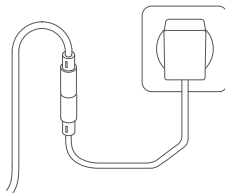

Device Binding & Initialization

1. Download the Aqara Home app

Search for "Aqara Home" in the Apple App Store, Google Play, Xiaomi GetApps, Huawei App Gallery, or scan the following QR code to download the Aqara Home app:



2. Add the product to the Aqara Home app

Please open the Aqara Home app, tap "Home" and then tap "+" in the top right corner to enter the "Add Device (Accessory)" page. Select "LED Strip T1" and the hub to be connected to, and add it according to instructions in the Aqara Home app, and wait for the voice prompt from the Hub.

For more details about the product, please visit <https://www.aqara.com/> or scan the QR code below to get the detailed electronic manual.



Product Specifications

LED Strip T1

Model: LEDS-K01/LEDS-K02/RLS-K01D/RLS-K02D

Rated Power: 5 W/m (30 Pieces × 5050 / 0.2W / RGB, 60 Pieces × 2835 0.2 W)

Color Temperature: RGB + 2700 K + 6500 K

Power Input (Power Supply): 100 - 240 V ~ 50 / 60 Hz Max. 1.2 A

Power Output (Power Supply): 24V DC 1.5 A

Power Input (LED Strip): 24V DC Max. 0.25 A/m

Wireless Protocol: Zigbee

Dimension of the Strip: 2000 × 12 × 2.8 mm

Working Temperature: -10 °C ~ 40 °C (14 °F ~ 104 °F)

Operating Humidity: 0 ~ 95 % RH, no condensation

Zigbee Operation Frequency: 2405-2475 MHz

Zigbee Maximum Output Power ≤ 13 dBm

What is in the Box: Light Strip (2m) × 1, Power Adapter × 1, Controller × 1, User Manual × 1

Manufacturer: Lumi United Technology Co., Ltd.

Address: Room 801-804, Building 1, Chongwen Park, Nanshan iPark, No. 3370, Liuxian Avenue, Fuguang Community, Taoyuan Residential District, Nanshan District, Shenzhen, China

Online Customer Service: www.aqara.com/support

Email: support@aqara.com

Note:

1. This product may be extended up to for 10 m;
2. The device shall not be installed in water or inflammable, explosive, high-temperature or high-humidity environment or a location directly exposed to the sunlight. The installation environment must be ventilated properly;
3. During the installation and use, do not damage the structure of the product. Do not beat or strike it with a heavy object, nor bind the Strip with metal wires tightly. Otherwise, the wires may be embedded in the Strip and cause a short-circuit fault, burning the Strip;
4. During the operation of the Strip, do not wrap or cover it with any object;
5. Avoid contact with any acidic, alkaline, or other chemicals;
6. This product needs to be adapted to SELV power of 24 VDC, 1.5 A;
7. Strip cutting needs to be in the marked part. The cut Strip cannot continue to be used. Please cut when it is powered off.
8. The external flexible cord of this luminaire cannot be replaced, if the cord is damaged, the luminaire shall be destroyed.
9. The light source of this luminaire is not replaceable, when the light source reaches its end of life the whole luminaire shall be replaced
10. Under normal use of conditions, this equipment should be kept a separation distance of at least 20cm between the antenna and the body of the user.



EU Declaration of Conformity

Hereby, [Lumi United Technology Co., Ltd] declares that the radio equipment type [LED Strip T1, LEDS-K01/ RLS-K01D/LEDS-K02/RLS-K02D] is in compliance with Directive 2014/53/EU. The full text of the EU declaration of conformity is available at the following internet address: <https://www.aqara.com/DoC/>

UK UK Declaration of Conformity **CA**

Hereby, [Lumi United Technology Co., Ltd] declares that the radio equipment type [LED Strip T1, LEDS-K01/ RLS-K01D/LEDS-K02/RLS-K02D] is in compliance with Directive 2017 (SI 2017 No. 1206, as amended by SI 2019 No. 696).

The full text of the UK declaration of conformity is available at the following internet address: <http://www.aqara.com/DoC/>.



WEEE Disposal and Recycling Information

All products bearing this symbol are waste electrical and electronic equipment (WEEE as in directive 2012/19/EU) which should not be mixed with unsorted household waste. Instead, you should protect human health and the environment by handing over your waste equipment to a designated collection point for the recycling of waste electrical and electronic equipment, appointed by the government or local authorities. Correct disposal and recycling will help prevent potential negative consequences to the environment and human health. Please contact the installer or local authorities for more information about the location as well as terms and conditions of such collection points.

FCC ID:2AKIT-LEDSK02

Federal Communications Commission (FCC) compliance statement:

1.This device complies with part 15 of the FCC Rules. Operation is subject to the following two conditions:

- (1) This device may not cause harmful interference, and
- (2) this device must accept any interference received, including interference that may cause undesired operation.

2.Changes or modifications not expressly approved by the party responsible for compliance could void the user's authority to operate the equipment.

Note: This equipment has been tested and found to comply with the limits for a Class B digital device, pursuant to part 15 of the FCC Rules. These limits are designed to provide reasonable protection against harmful interference in a residential installation. This equipment generates, uses and can radiate radio frequency energy and, if not installed and used in accordance with the instructions, may cause harmful interference to radio communications. However, there is no guarantee that interference will not occur in a particular installation. If this equipment does cause harmful interference to radio or television reception,

which can be determined by turning the equipment off and on, the user is encouraged to try to correct the interference by one or more of the following measures:

- Reorient or relocate the receiving antenna.
- Increase the separation between the equipment and receiver.
- Connect the equipment into an outlet on a circuit different from that to which the receiver is connected.
- Consult the dealer or an experienced radio/TV technician for help.

RF Exposure statement:

This equipment complies with FCC radiation exposure limits set forth for an uncontrolled environment. This equipment should be installed and operated with minimum distance of 20 cm between the radiator and your body. This transmitter must not be co-located or operating in conjunction with any other antenna or transmitter.

IC:22635-LEDSK02

IC:22635-RLSK02D

IC NOTICE TO CANADIAN USERS

This device contains licence-exempt transmitter(s)/receiver(s) that comply with Innovation, Science and Economic Development Canada's licence-exempt RSS(s). Operation is subject to the following two conditions:

- (1) This device may not cause interference.
- (2) This device must accept any interference, including interference that may cause undesired operation of the device.

This Class B digital apparatus complies with Canadian ICES - 003.

This device complies with RSS - 247 of Industry Canada. Operation is subject to the condition that this device does not cause harmful interference.

This equipment complies with IC radiation exposure limits set forth for an uncontrolled environment. This equipment should be installed and operated with minimum distance of 20 cm between the radiator and your body. This transmitter must not be co-located or operating in conjunction with any other antenna or transmitter.